

Section 02 MAINTENANCE

Subsection 04 (WATER-FLOODED ENGINE)

Whenever the engine is stopped, all the valves close thus preventing water from being ingested in the engine.

Supercharged 4-TEC Engines

Inlet duct should be disconnected from supercharger inlet tube to validate presence of water.

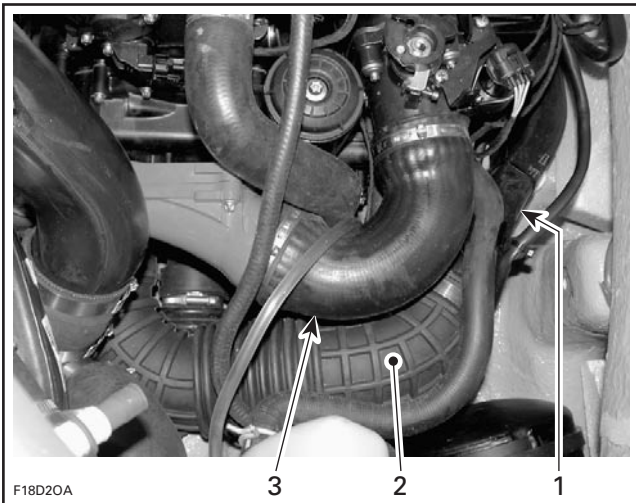

1. Inlet duct
2. Inlet hose
3. Outlet hose

If water is suspected to be in the supercharger, remove its outlet hose and siphon water out. Ensure that siphon tube is inserted to the lowest point in the supercharger.

If necessary, remove supercharger housing.

All 4-TEC Engines

If water is suspected to be in the intake and the exhaust system, it must be drained as follows:

Remove the intake manifold and drain it. Then suck out the water from the intake valve ports. Refer to subsection INTAKE SYSTEM.

Remove the water from oil/air separator breather hose.

Remove the exhaust pipe and drain it. Then either remove the mufflers to drain them or siphon the water out of them. Refer to subsection EXHAUST SYSTEM.

If water gets in the oil (oil will be milky), change the engine oil and filter as follows.

Oil Change Procedure (water-contaminated oil)

1. Using the oil VAC (P/N529 035 880), siphon oil from reservoir through dipstick hole.

CAUTION: Never crank or start engine when siphon tube is in dipstick hole. Never start engine when there is no oil in engine.

2. Remove the oil vac tool from the dipstick hole.
3. While in drowned engine mode, crank the engine for 5 seconds.
4. Remove the oil filter cap and the oil filter.
5. Again, siphon oil from the reservoir.
6. Put a rag under the scavenge oil pump cover.
7. Remove the scavenge oil pump cover drain plug and install a fitting (P/N 293 710 037).

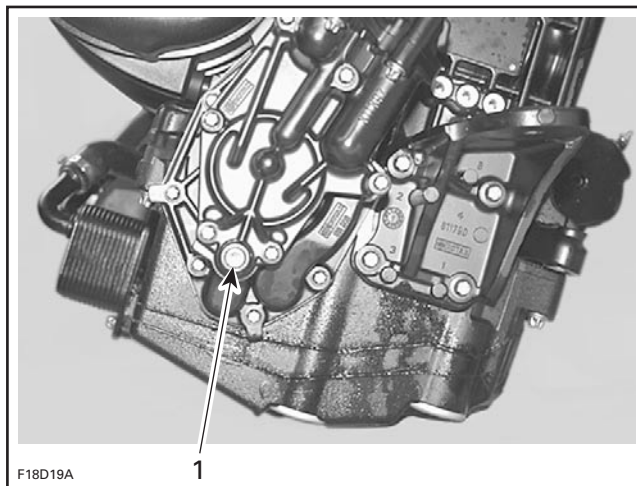

1. Scavenge oil pump cover drain plug

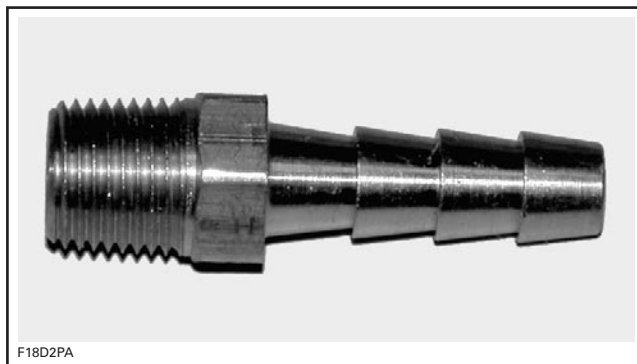

8. Connect the oil vac tool Bombardier (P/N 529 035 880) to the fitting.
9. The front of the engine must be tilted down approximately 15 degrees to facilitate the removal of the oil. Raise the rear of the boat accordingly. Siphon the oil from the fitting.

MAGNETO SYSTEM

717 Engines

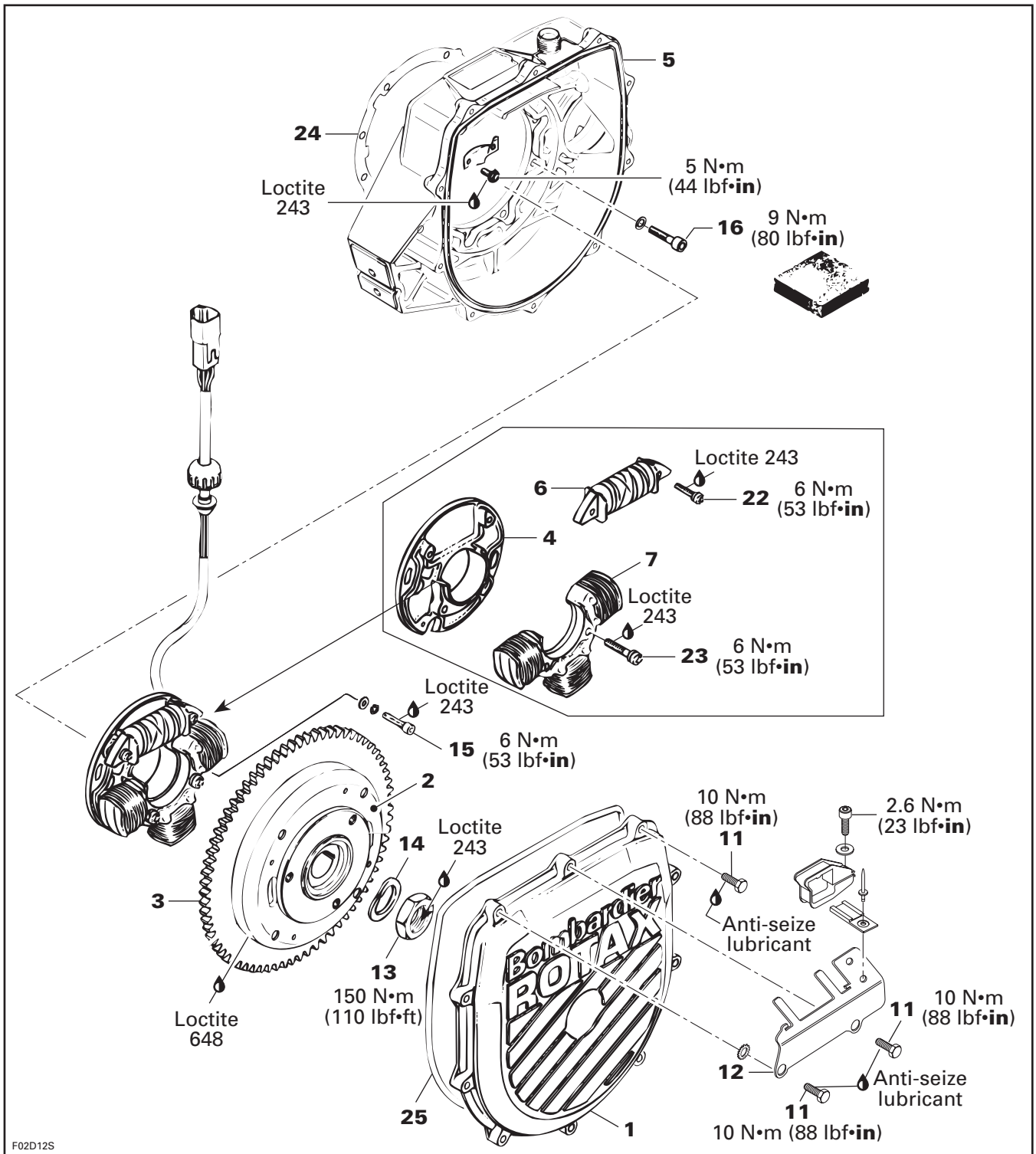

F02D12S

4-TEC Supercharged Engines

