









INDEX

GENERAL INFORMATION	 GEN INFO	1
SPECIFICATIONS	 SPEC	2
PERIODIC INSPECTION AND ADJUSTMENT	 INSP ADJ	3
FUEL SYSTEM	 FUEL	4
POWER UNIT	 POWR	5
JET PUMP UNIT	 JET PUMP	6
ELECTRICAL SYSTEM	 ELEC	7
HULL AND HOOD	 HULL HOOD	8
TROUBLE ANALYSIS	 TRBL ANLS	9



**CHAPTER 5
POWER UNIT**

ENGINE UNIT REMOVAL	5-1
EXPLODED DIAGRAM (XL760)	5-1
REMOVAL AND INSTALLATION CHART	5-1
EXPLODED DIAGRAM (XL1200)	5-2
REMOVAL AND INSTALLATION CHART	5-2
SERVICE POINTS	5-3
Shim removal	5-3
Mount bracket inspection	5-3
Coupling clearance inspection	5-3
 REED VALVE	 5-4
EXPLODED DIAGRAM (XL760)	5-4
REMOVAL AND INSTALLATION CHART	5-4
EXPLODED DIAGRAM (XL1200)	5-5
REMOVAL AND INSTALLATION CHART	5-5
SERVICE POINTS	5-6
Reed valve inspection	5-6
 EXHAUST RING	 5-7
EXPLODED DIAGRAM (XL760)	5-7
REMOVAL AND INSTALLATION CHART	5-7
EXPLODED DIAGRAM (XL1200)	5-8
REMOVAL AND INSTALLATION CHART	5-8
 EXHAUST CHAMBER REMOVAL	 5-9
EXPLODED DIAGRAM (XL760)	5-9
REMOVAL AND INSTALLATION CHART	5-9
EXPLODED DIAGRAM (XL1200)	5-10
REMOVAL AND INSTALLATION CHART	5-10
 EXHAUST CHAMBER	 5-11
EXPLODED DIAGRAM (XL760)	5-11
REMOVAL AND INSTALLATION CHART	5-11
EXPLODED DIAGRAM (XL1200)	5-12
REMOVAL AND INSTALLATION CHART	5-12
 MUFFLER	 5-13
EXPLODED DIAGRAM (XL760)	5-13
REMOVAL AND INSTALLATION CHART	5-13
EXPLODED DIAGRAM (XL1200)	5-14
REMOVAL AND INSTALLATION CHART	5-14



INTERMEDIATE HOUSING REMOVAL
EXPLODED DIAGRAM

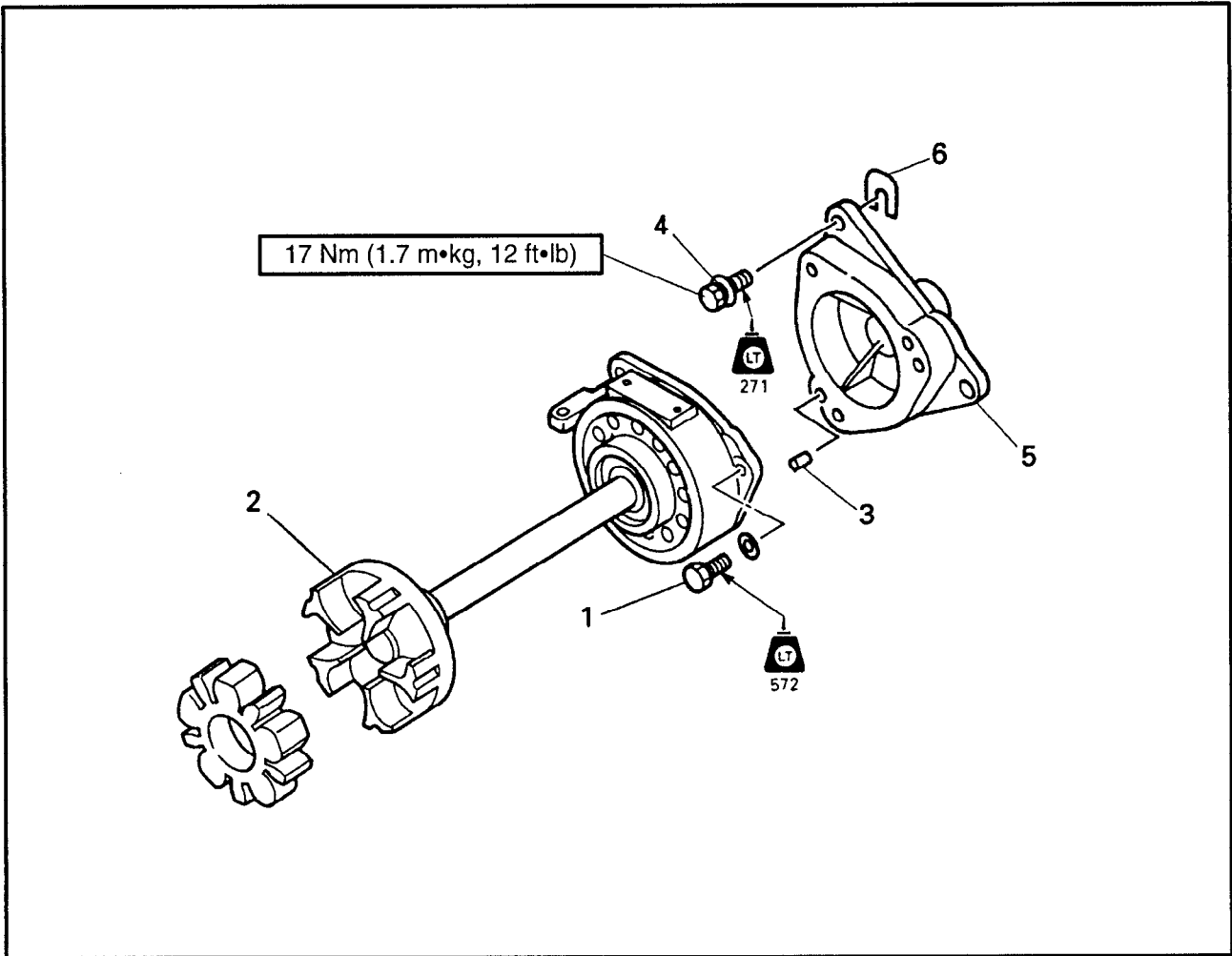

REMOVAL AND INSTALLATION CHART

Step	Procedure/Part name	Q'ty	Service points
	INTERMEDIATE HOUSING REMOVAL		Follow the left "Step" for removal.
	Engine unit		Refer to "ENGINE UNIT REMOVAL".
1	Bolt (with washer)	3	
2	Bearing housing assembly	1	
3	Pin	2	
4	Bolt (with washer)	3	
5	Housing	1	
6	Shim	*	NOTE: _____ Install the previously marked shims back into their original location. _____
			Reverse the removal steps for installation.

*: As required